

More information
on the product page

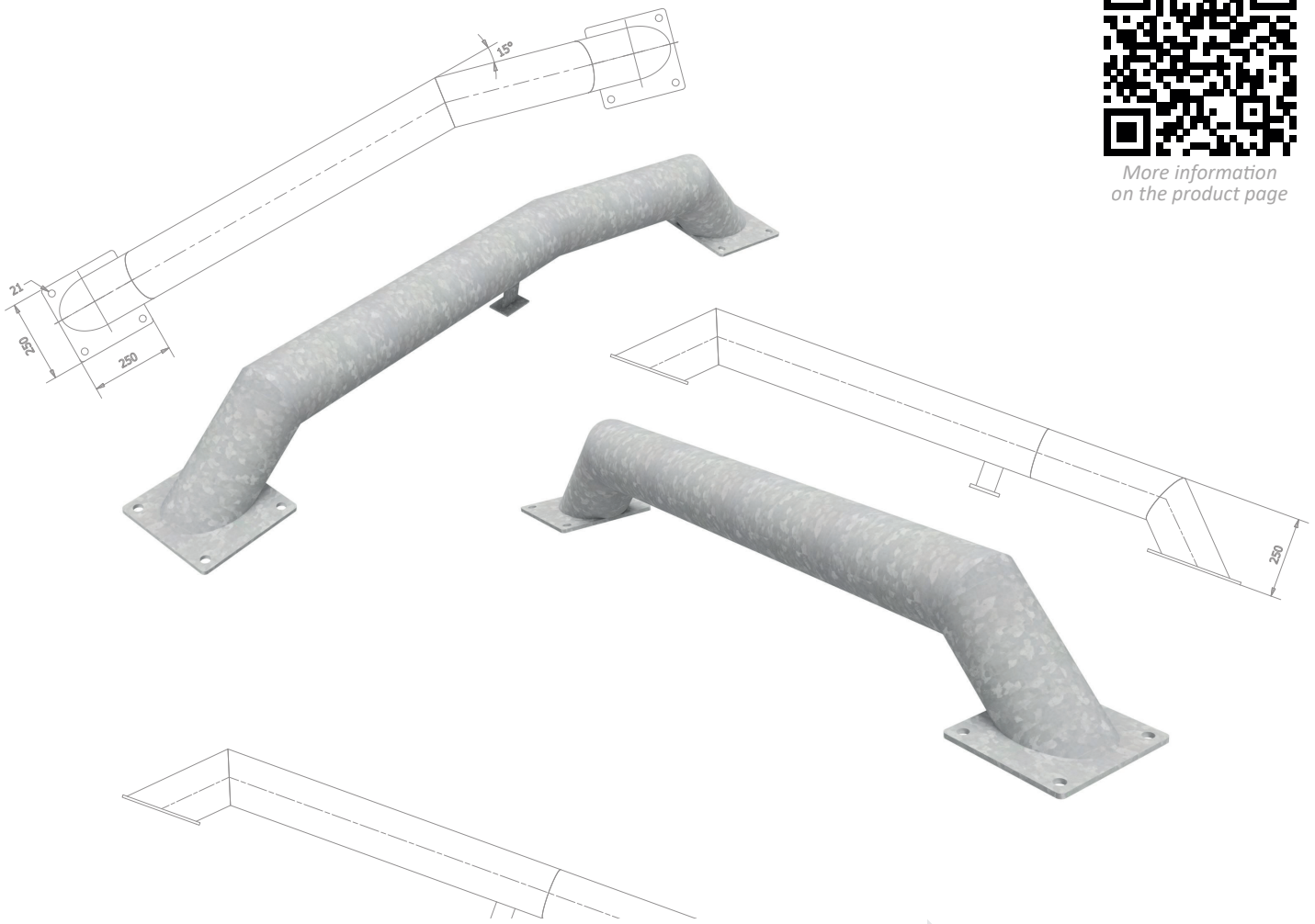

AMTR-N

Wheel Guides

- Robust and reliable steel structure
- Quick and safe loading
- Precise positioning of the transport vehicle in relation to the dock
- Optimising the handling process
- Avoiding accidental damage to the docking system structure
- Additional loading and unloading protection
- Improved working comfort
- Easy installation
- Possibility to adapt the product to customer requirements



AC 082

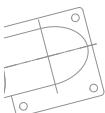

General information

The AMTR-N guides are an accessory to the docking system that allows precise positioning of the transport vehicle relative to the internal or external dock. This optimises the loading process and avoids accidental damage to the mounted structures. The wheel guides are mainly used in logistics centres and large-scale retail premises. Due to their usefulness, they are increasingly used in industrial buildings, smaller commercial buildings and workshops.

Installation

Correct installation is very important. The homing device must be permanently fixed to the ground of the manoeuvring area, and foundations must be poured for its feet, which will be carried out by the customer according to installation drawings provided by the sales representative. The guides are fixed to the foundations using the ring anchors included in the installation kit.

Types of guides



AMTR-N STRAIGHT guide

The AMTR-N STRAIGHT steel guide is 1840 mm long. Its frame and feet are made of circular steel profiles with a diameter of 159 mm. The whole is attached to square bases made of flat sheet metal.



AMTR-N ANGLED guide

The AMTR-N ANGLED wheel guide is 2000 mm long and is angled at 15 degrees. Its frame and feet are made of circular steel profiles with a diameter of 159 mm. The whole is attached to square or rectangular bases made of flat sheet metal.

Technical data*

Application	Handling systems
Length	1840 mm
Height	250 mm
Base dimensions	250x250 mm
Tube diameter	159 mm
Finish	Galvanised

Application	Handling systems
Length	2000 mm
Height	250 mm
Base dimensions	250x250 mm
Tube diameter	159 mm
Finish	Galvanised

The set includes a right and a left guide.

* Possibility to adapt the product to customer requirements.

Additional options

- Painted in any RAL colour
- Possibility to produce in other dimensions
- Guides can be produced to be concreted in